

ARRIMAGE

→ 6541 **vrac**
→ 6541B **B**

Anneau d'amarrage, qui se fixe sur ridelles, châssis ou plancher. Acier zingué.

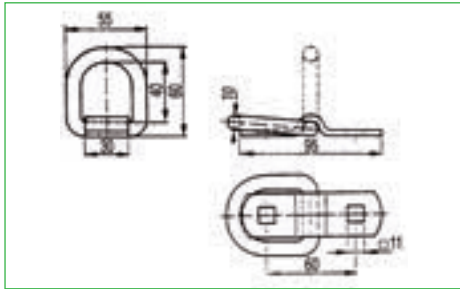

→ 6540

Idem 6541. Avec cuvette d'encastrement.

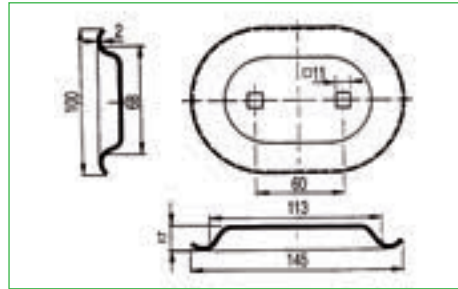

→ 6542 **vrac**
→ 6542B **B**

Anneau d'amarrage encastré. Acier galvanisé.

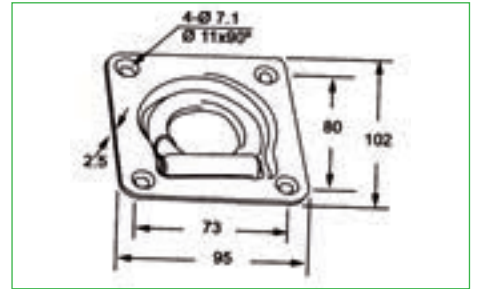

→ 6726

Platine de renfort. Dim. 175 x 125 x 25 mm.

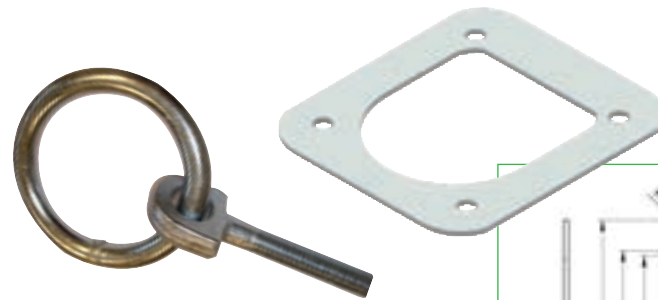
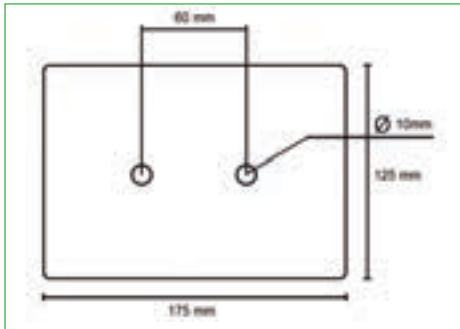

→ 6958

Plaque de renfort.

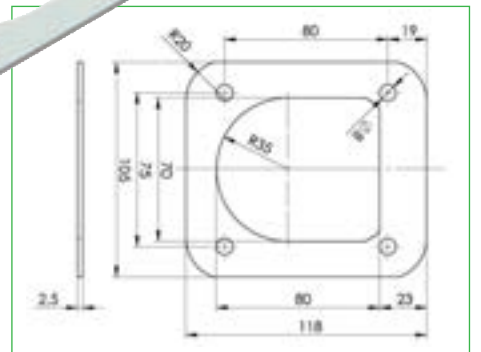

→ 6533 **vrac**
→ 6533B **B**

Anneau à vis. Pas de vis : M 10 x 45. Anneau : Ø 50 mm.



→ 6543 **vrac**
→ 6543B **B**

Pontet rabattable. Acier zingué.

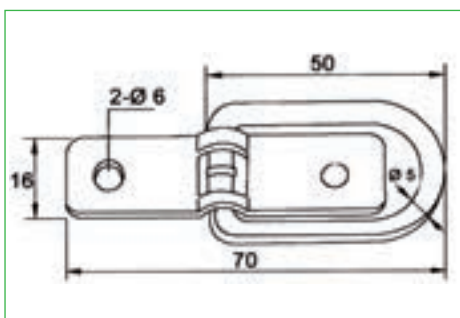

→ 6535A **vrac**
→ 6535AB **B**

Anneau d'arrimage à encastrer.

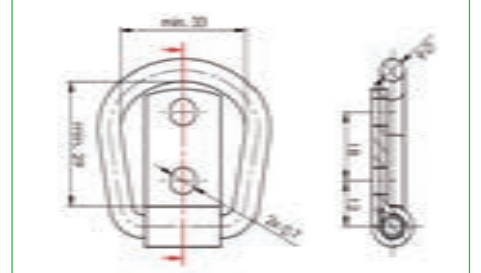
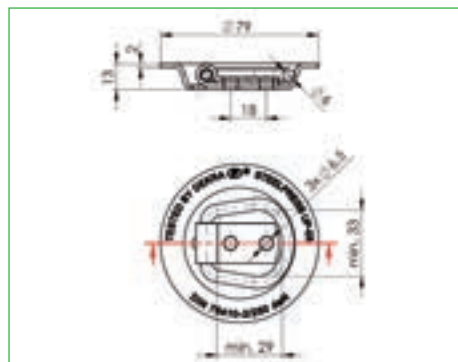

→ 6535 **vrac**
→ 6535B **B**

Pontet rabattable.

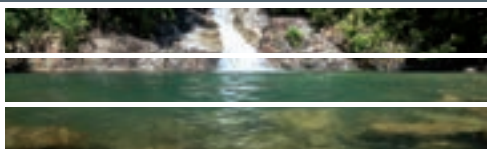

BRIDES D'ARRIMAGE



BRIDES D'ARRIMAGE

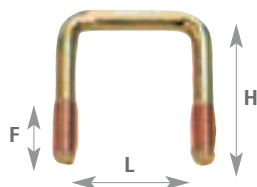

Livrées avec écrou nylstop

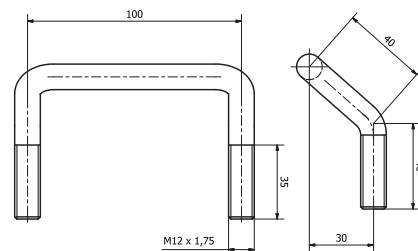

→ 6932

Etrier de sanglage.

CODE	Tube carré	Largeur	Hauteur	Filetage
7200	30 x 30	30	50	M10/25
7201	40 x 40	40	60	M10/25
7202	60 x 60	60	85	M10/25
7203	80 x 80	80	110	M10/25

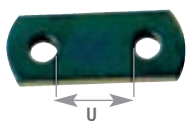

Plaquettes 2 trous

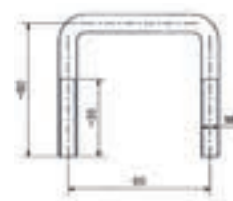

→ 7838

Etrier Ø 8 mm.

CODE	Tube carré	Largeur	Hauteur	Filetage
7215	80 x 40	80	65	M10/25
7216	80 x 60	80	85	M10/25
7217	120 x 60	120	85	M10/25

CODE	U
7229	30
7228	40
7227	60
7226	80
7225	120

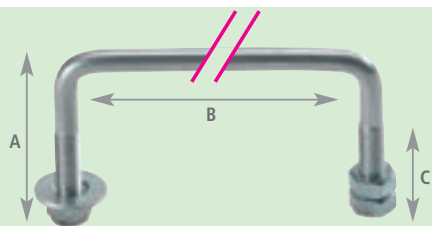

→ 6666B

Kit arrimage.

2 utilisations : coulissant ou fixe.

2 Brides Ø 7 mm.

A 50, B 90, C 30.

- + 4 écrous nylstop Ø 8 plat 13
- + 4 Rondelles - 10,5 x 22 x 2
- + 8 écrous - ø 8 plat 13

BOULONNERIE

Rondelles

CODE	Cotes
R10	10,5 x 22 x 2
R12	13 x 27 x 2,5

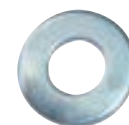

Ecrous Nylstop

CODE	Cotes
EN10	Ø 10 - plat 17
EN12	Ø 12 - plat 19



BARRES D'ARRIMAGE



→ 6776

Rail alu AERO 3 x 0,5 m.
Ø 20 mm.



→ 6777

Plastique de finition gris.

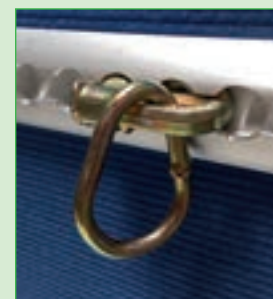
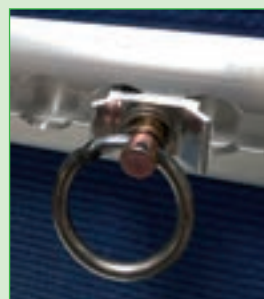

→ 6727

Anneau d'arrimage.

→ 6728

Rail d'arrimage.
Poids 2,5 kg.
3050 x 132 x 11,5 mm.



→ 6778

Pion + anneau Ø 29 mm
pour rail AERO (800 daN).



→ 6780

Pion double + anneau Ø 40 mm
pour rail AERO (1800 daN).